

The gravimetric dosing units DMG series have been designed to dose masterbatch, micropellets and regrind material. Each dosing unit has a number of dosing cylinders driven by a stepper motor to satisfy throughputs from 70g/h to 72 kg/h. The microprocessor control with an 8-inch color touchscreen guarantees a good graphical interface with the operator. The loss-in-weight control ensures a perfect dosing even when density of the components changes. The static mixer mixes dosed material with virgin material. It is possible to install a system with two independent dosing stations with one operator interface.



TECHNICAL SPECIFICATIONS:

- Continuous measurement of weight with loss;
- Self-calibration;
- Built-in control of the hopper loader;
- Storage function for recipes;
- Ethernet, Modbus and Profibus interfaces;
- Menu-driven control and LCD display;
- Version with 8-inch color touchscreen to control single stations or multi-component stations;
- It can be installed on injection molding machines or extruders.

ADDED VALUE:

- Extremely precise dosing resulting in significant increases in quality and cost savings.
- Always reliable thanks to the continuous calibration of the gravimetric system.
- Easy to use thanks to its simple operator interface.

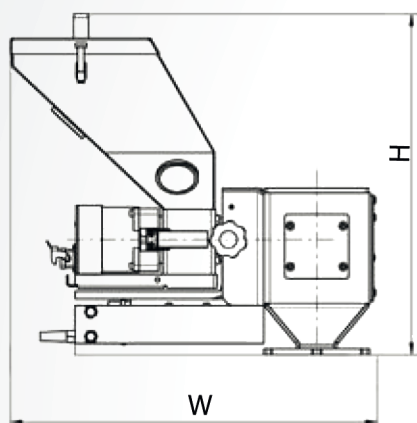

TECHNICAL DATA	Cylinders		DMG1
Minimum-maximum throughput	A8	kg/h	0.07-5.8
	A15		0.8-18
	A20		1.8-72
Maximum N° of material			2
Hopper volume		l	6
Motor power		W	80
Mixing chamber capacity		dm ³	1
Voltage/Frequency		V/Hz	230/50-60
Noise level		dB(A)	<80
Dimensions WxDxH		mm	331x574x492
Weight		kg	19